

To Install the Antenna Adaptor

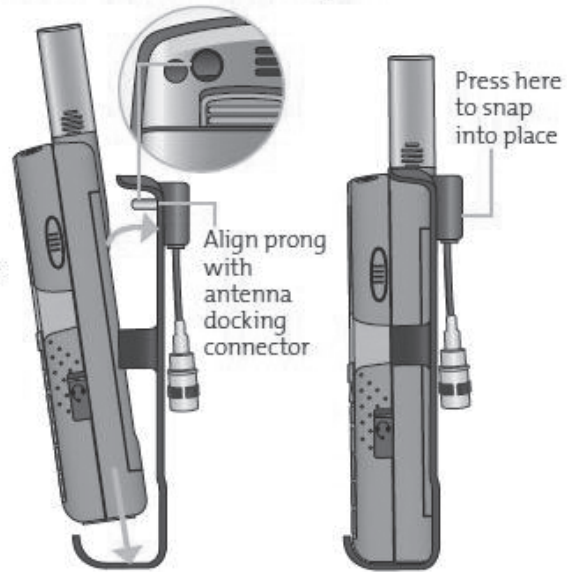

Note: Your phone was shipped with a plug protector for the antenna connector, you must remove this prior to using the Antenna Adaptor.

1. Slide the phone into the antenna adaptor.
2. Rotate until the back of the phone meets the adaptor.

Auxiliary Antenna Adaptor

Allows you to easily attach the auxiliary antenna to the back of your Iridium 9555 handset. The auxiliary antenna allows for in-vehicle use of your Iridium handset.

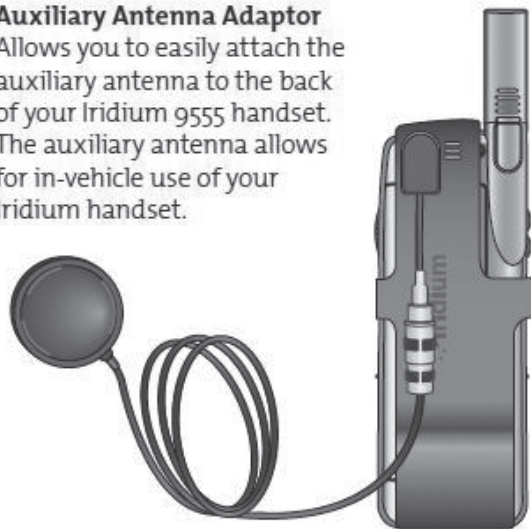

SATELLITE HIRE
"Utilising the latest technology"

Iridium 9555 Hire Fleet User Guide

Satellite Hire Australia Pty Ltd

satellitehire.com.au

hire@satellitehire.com.au

1800SATELLITE (1800 728 355)

SATELLITE HIRE PHONE MANUAL



Helpful Hints

- Need clear view of sky, outdoors, away from buildings and tall structures. Fully extend antenna into a vertical position.
- Wait until registration is complete (you will see registered on screen).
- To dial, enter area code and number, + OK.
For a mobile enter number + OK.
- Talk with antenna above your head and vertical to the ground.



1. Extend the antenna completely



2. Rotate the antenna to either the left or right detent.



3. Make sure the antenna is pointing skyward.

To Send a Text Message

Using the soft keys perform the following:

Press the Menu

Scroll down to Messages and select

Select Create Message

Enter Text message to be sent

Select Options

Select Send

Select New Recipient

Select Add

Select Enter Number

Enter recipient mobile number ie +61 400 123 456

You **MUST** have +61 and drop leading zero of the mobile number

Select OK

NOTE: Non-Telstra mobiles may have difficulty in sending text messages to the satellite phone



Do not let your battery, charger, or satellite phone come in contact with water.

How to make a call

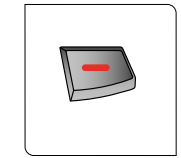
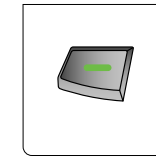
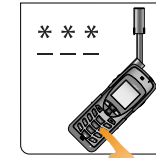
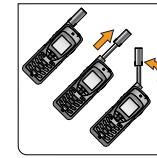

- The phone must be used outside, away from trees and tall buildings.
- Extend the antenna completely and rotate so that it points directly upwards.
- Power-on by pressing black button on the top of the phone, hold down for 5 seconds.
- Phone will display 'searching for network' and then 'registered'.

To make a call within Australia

To call a fixed line in Melbourne (include area code) Dial 03 XXXX XXXX

To call a mobile in Australia Dial 04 XXXX XXXX

To call a Telstra Satellite phone Dial 0147 XXX XXX

To make a call from outside Australia

To call a fixed line in Melbourne Dial 0011 61 3 XXXX XXXX

To call a mobile in Australia Dial 0011 61 4 XXXX XXXX

To call another country Dial 0011 - country code - number

To receive a call, your phone must be on and registered with the Satellite.

1. First, rotate and fully extend the Satellite antenna
2. Press the green key

Charging the Battery



The charger plugs into the phone on the lower left hand side as per above picture, when charging the battery indicator will flash. Once fully charged the battery icon will remain constant.